

Composite dry sliding bushings, metric dimensions

Principal dimensions			Basic load ratings		Mass	Designation
d	D	B	dynamic C	static C0	kg	-
mm			kN			
<b>40</b>	44	30	140	290	0,053	PCM 404430 M

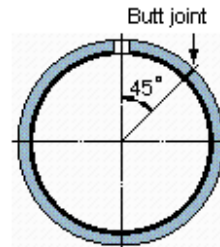
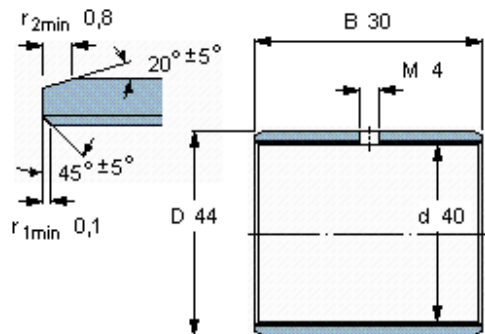

**Specific load factor** K 120  
**Material constant**  $K_M$  1900